



7.0

DRAWINGS AND
DIAGRAMS

Drawing and Diagrams

- [a HC campus plan diagrams- existing](#)
- [b HC campus plan diagrams- short term](#)
- [c HC campus plan diagrams- mid term](#)
- [d HC campus plan diagrams- long term](#)
- [e HC proposed sign locations](#)
- [f HC landscape drawings](#)
- [g HC utility drawings](#)

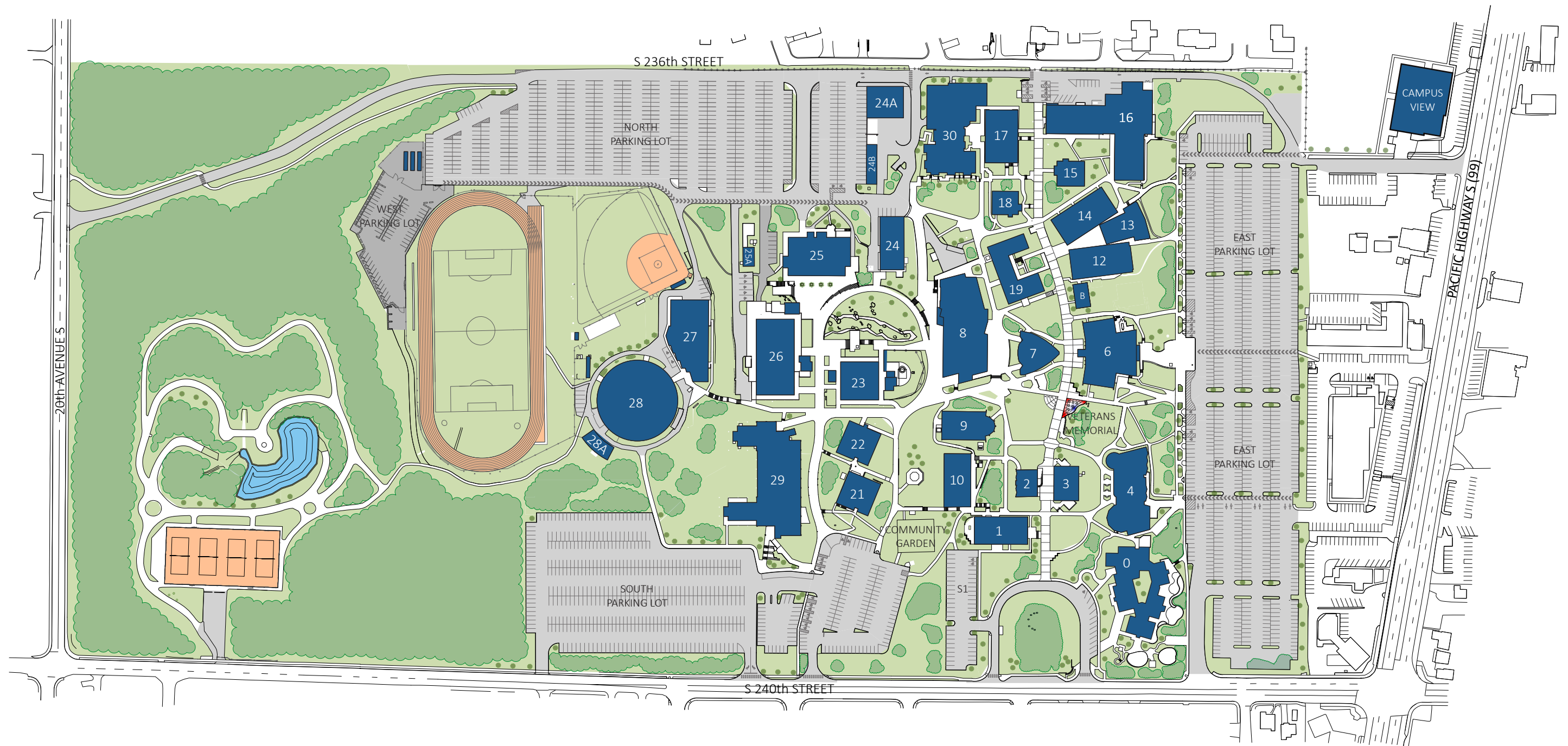

- # EXISTING BUILDINGS
- PEDESTRIAN WALKWAYS
- PARKING ZONE
- LAWNS & PLANTINGS

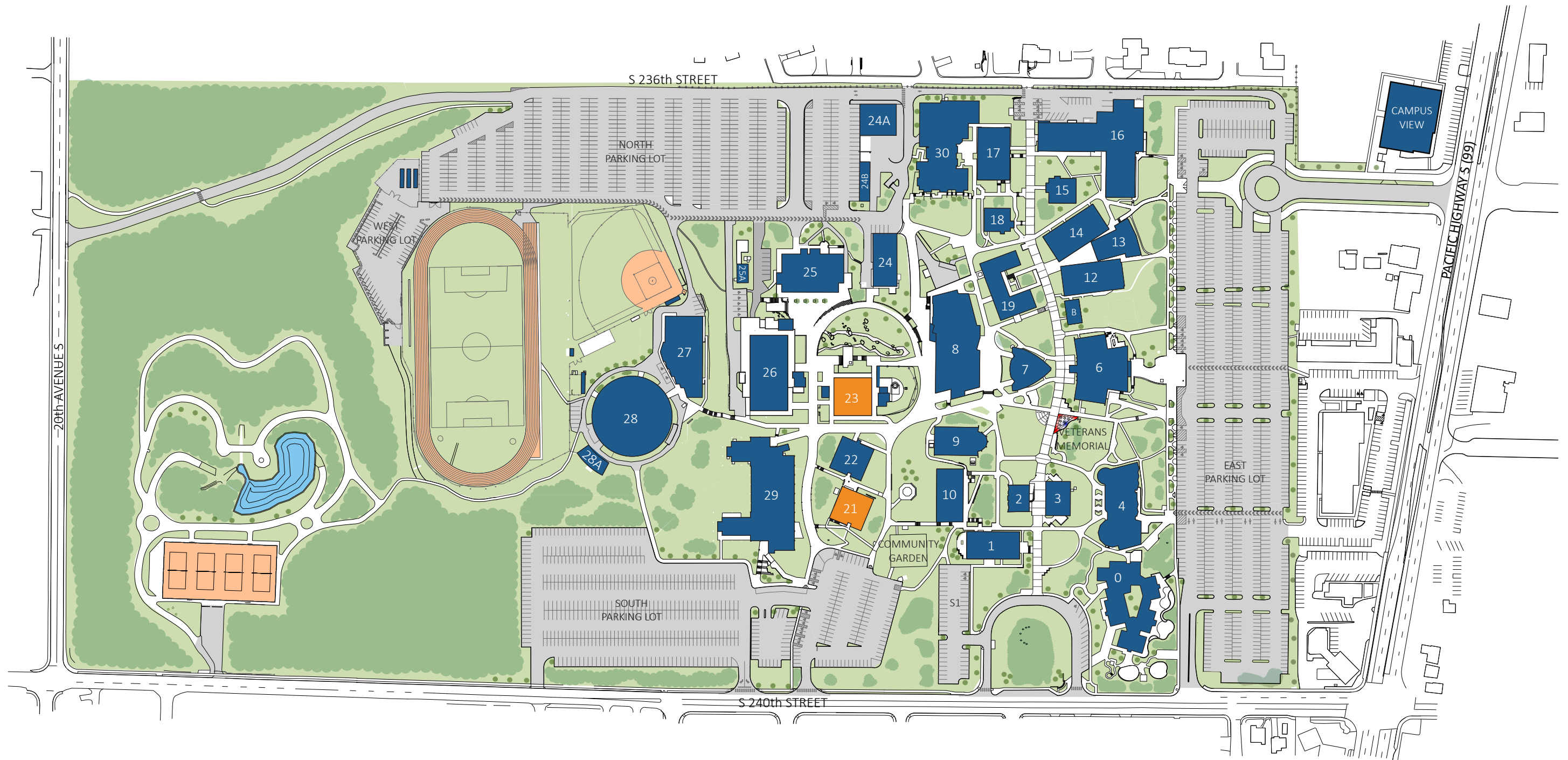

- # EXISTING BUILDINGS
- PARKING ZONE
- LAWNS & PLANTINGS
- PEDESTRIAN WALKWAYS
- MINOR IMPROVEMENTS

SHORT TERM PROJECTS - 2023-25

- A. Minor Improvements 2021-23:
 - Instructional Relocation Phase 1 (Complete June 2023)
 - Bldg. 21 PFT Lab Conversion to 2 Classrooms
 - Bldg. 23 1st Floor Renovation for Veterans Center
 - Bldg. 23 3rd Floor Renovation to move Faculty Offices from Bldg. 15
- B. College Way Campus Entrance Improvements by Sound Transit (Complete Summer 2023)
- C. East Parking Lot Overlay (Complete Summer 2023)
- D. Campus Signage Phase 2- On-Campus Wayfinding (TBD)
- E. Minor Improvements 2023-25:
 - Instructional Relocation Phase 2 (Complete 2025)
 - Bldg. 23 1st & 2nd Floor Renovation

SHORT TERM CAMPUS PLAN - 2023-25

HIGHLINE COLLEGE MASTER PLAN
MARCH 2023



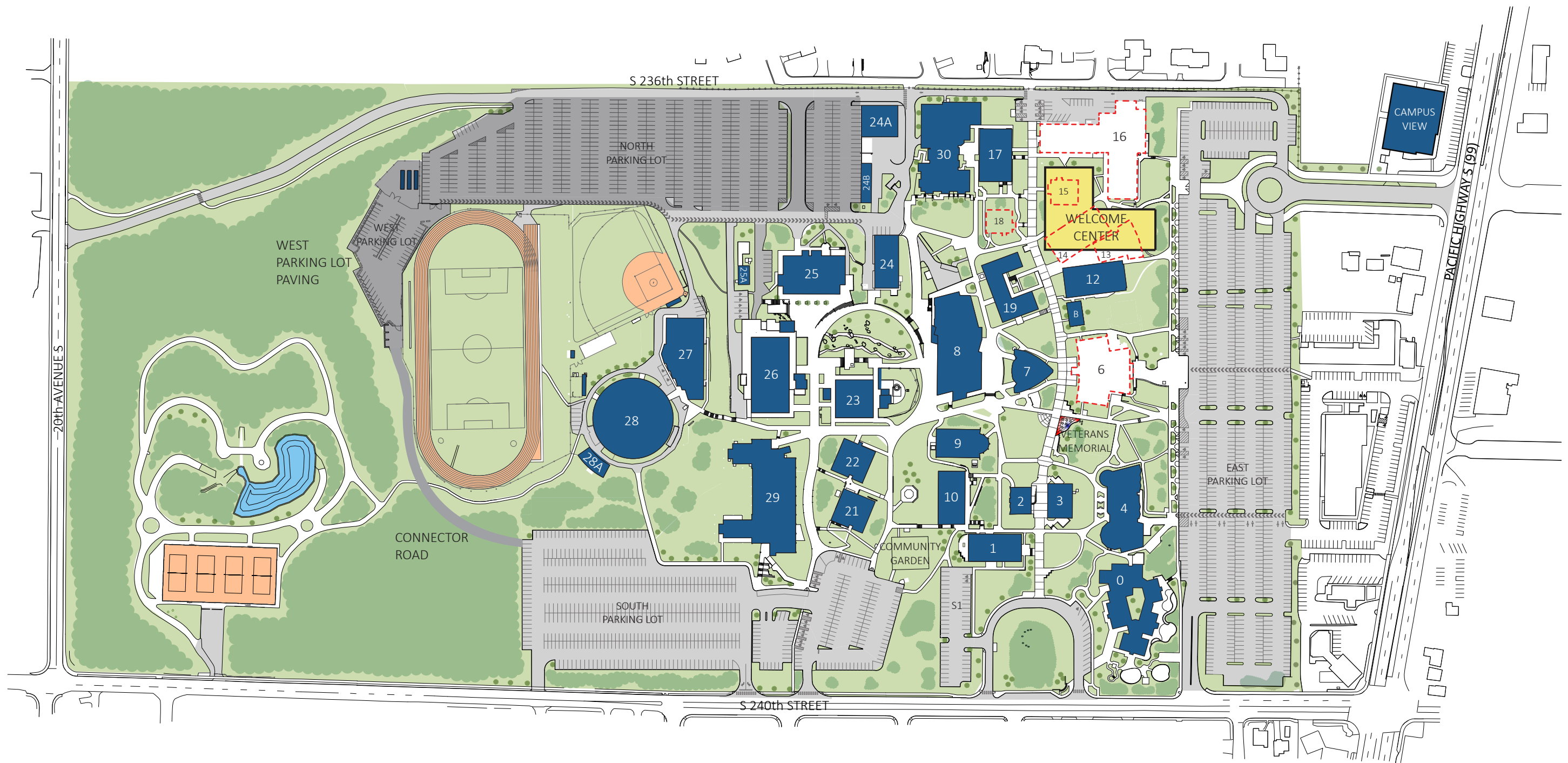

- # EXISTING BUILDINGS
- LAWNS & PLANTINGS
- PROPOSED DEMOLITION
- PEDESTRIAN WALKWAYS
- PARKING ZONES
- NEW CONSTRUCTION

MID TERM PROJECTS - 2025-29

- A. North Parking Lot Overlay (Complete 2025-27)
- B. Connector Road & West Parking Lot Paving (Complete 2027-29)
- C. Welcome Center for Student Success (Complete 2029)
- Includes demolition of bldgs. 6, 13, 14, 15, 16 & 18

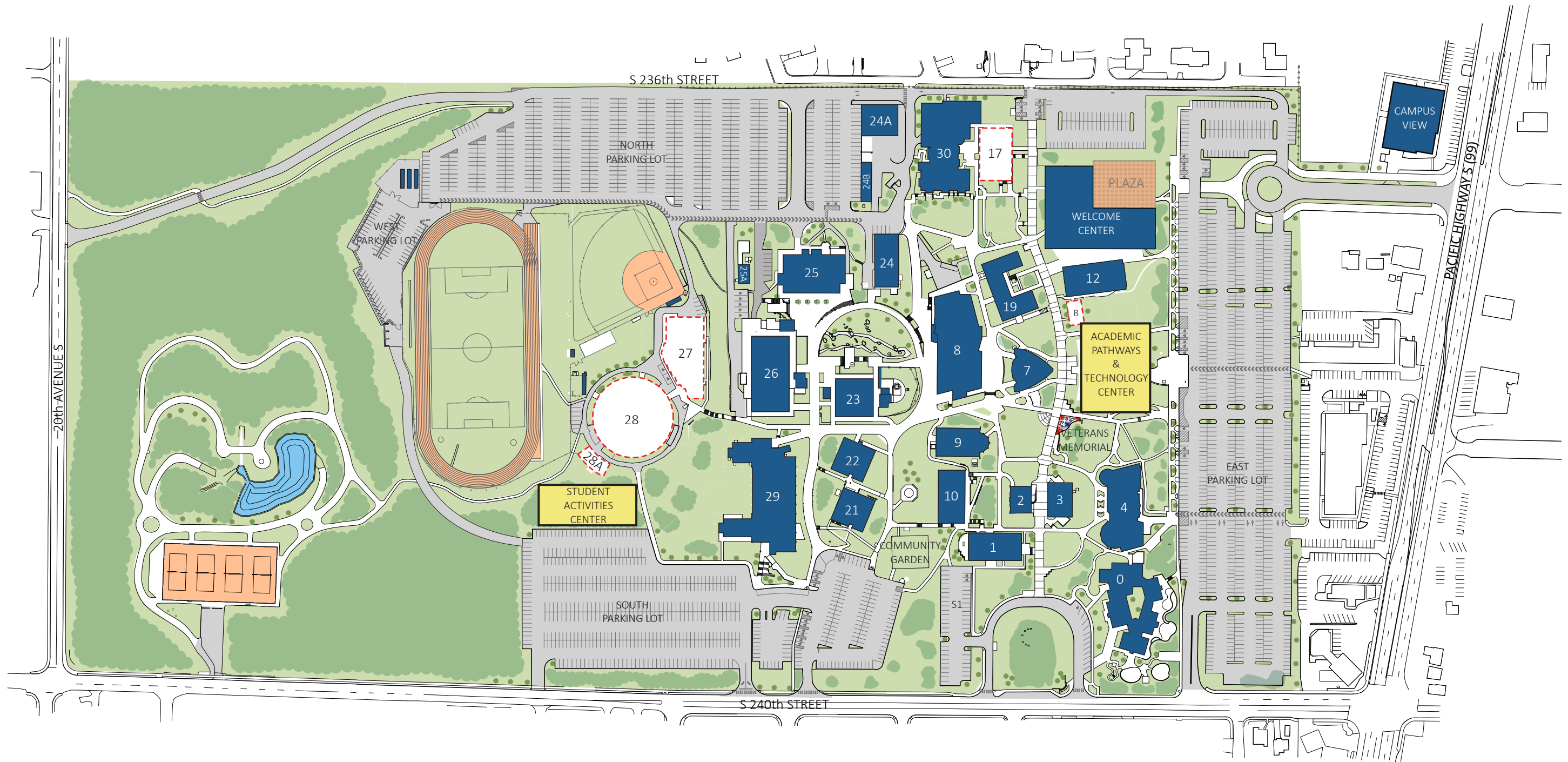

- # EXISTING BUILDINGS
- PROPOSED DEMOLITION
- LAWNS & PLANTINGS
- PEDESTRIAN WALKWAYS
- PARKING ZONES
- NEW CONSTRUCTION

LONG TERM PROJECTS - 2029-33

- A. Academic Pathways & Technology Center
- Includes demolition of bldgs. 12B, 17, 27 & 28
- B. Student Activities Center (COP Project)
- Includes exterior improvements- track resurfacing, turf replacement, bleachers & parking

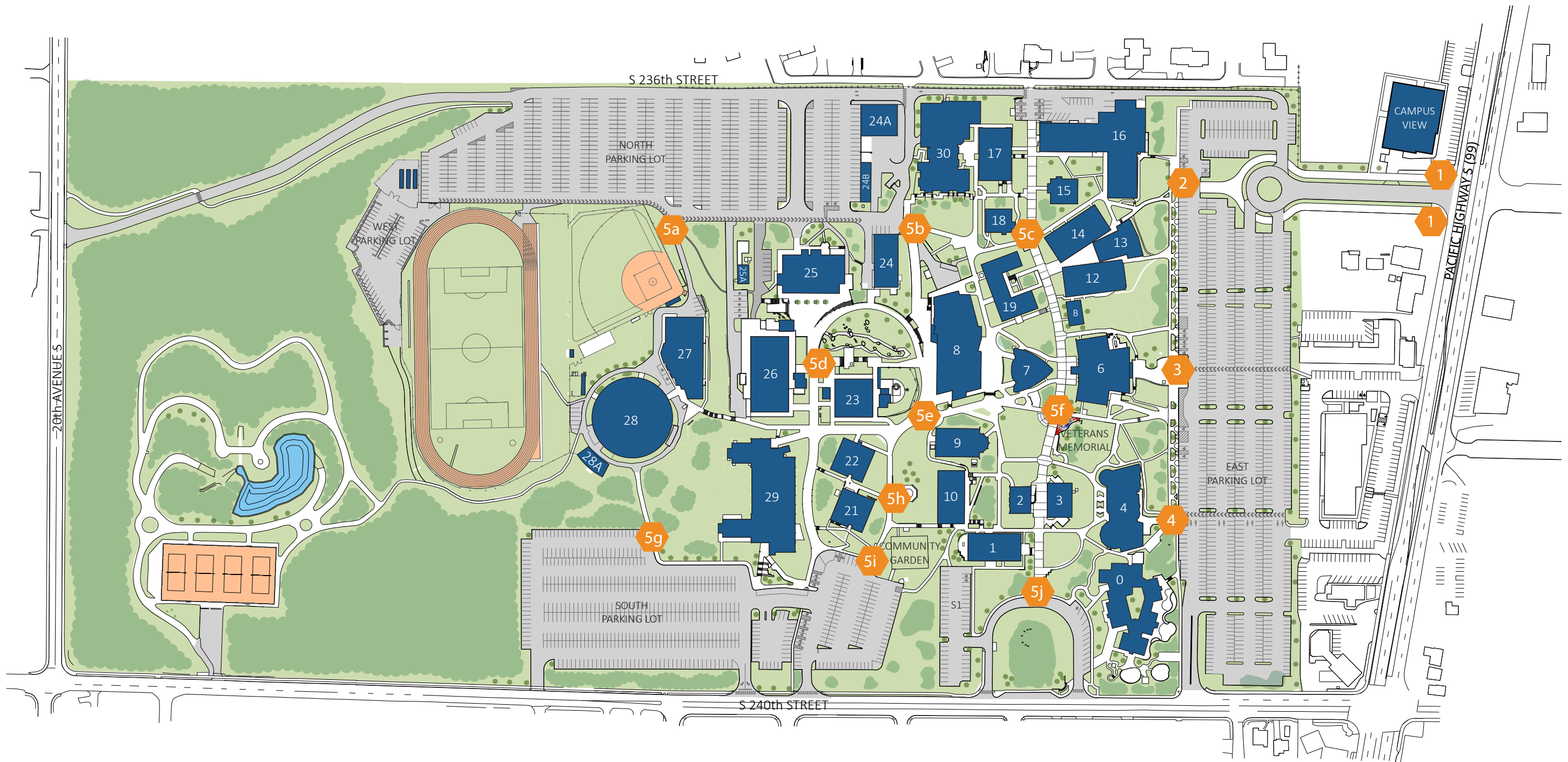

 PROPOSED SIGNS

- 1. Pacific Highway Entrance/Main Entrance
- 2. End of East Entrance Allee/North Pedestrian and Vehicular Entrance
- 3. Main Pedestrian Entrance
- 4. South Pedestrian Entrance
- 5a-j. I-spot Locations

PROPOSED SIGN LOCATIONS

HIGHLINE COLLEGE MASTER PLAN
MARCH 2023

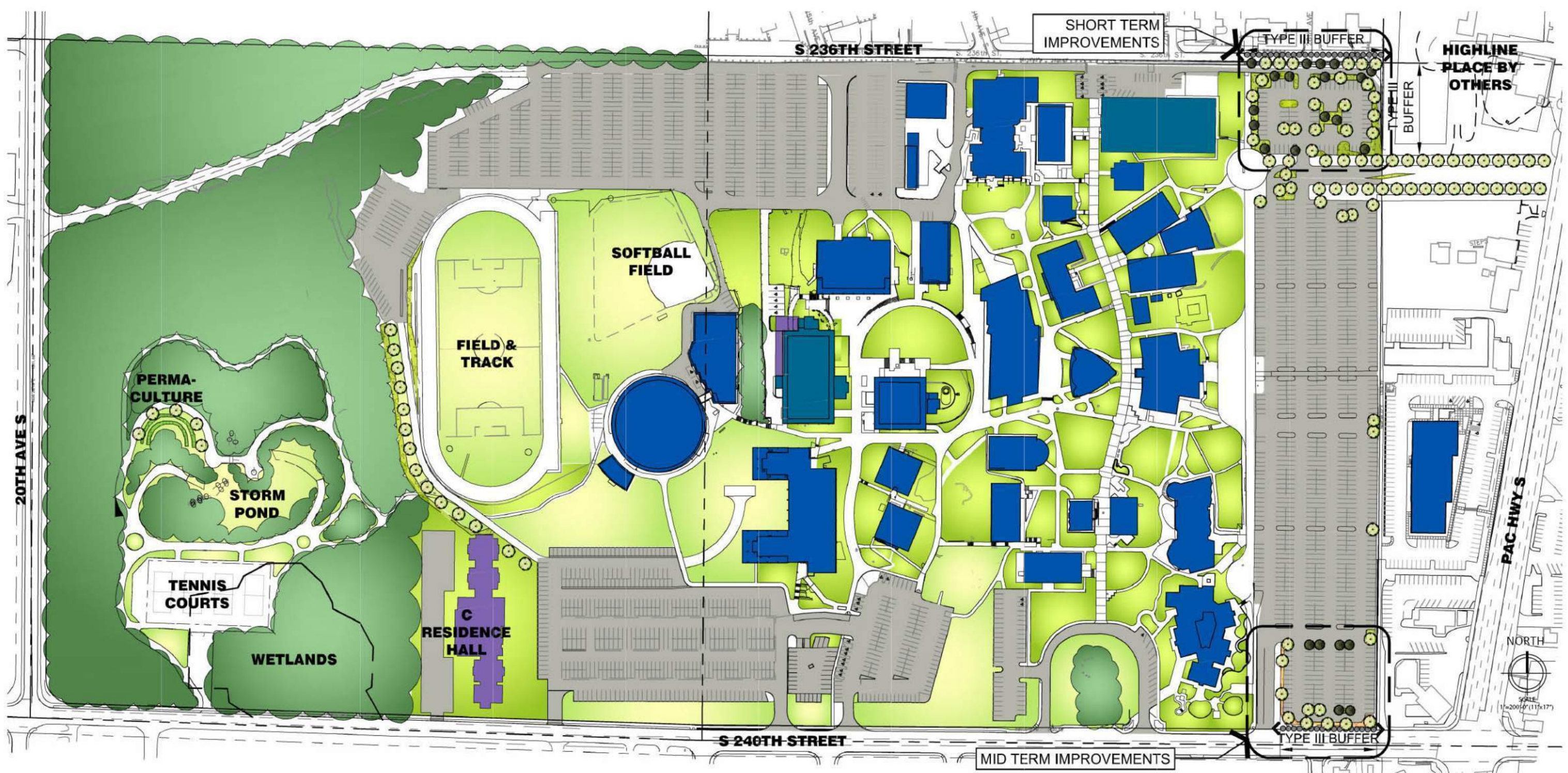

MASTER PLAN PLANT SCHEDULE

	DECIDUOUS TREES ACER RUBRUM / BOWHALL MAPLE LIRIODENDRON TULIPIFERA / TULIP TREE
	EVERGREEN TREES 6' HT. MIN CHAMAECYPARIS OBTUSA / HIKOKI FALSE CYPRESS THUJA PLICATA / WESTERN RED CEDAR TSUGA HETEROPHYLLA / WESTERN HEMLOCK
	NATIVE PLANT MIX LANDSCAPE AREAS AROUND BUILDINGS ARCTOSTAPHYLOS UVA-URS / KINKINNICK DIGNETHIA FORMOSA / WESTERN BLEEDING-HEART HOLDISCUS DISCOLOR / OCEAN SPRAY POLYSTICHUM MUNITUM / WESTERN SWORD FERN SYMPHORICARPOS ALBUS / COMMON WHITE SNOWBERRY VACCINIUM OVATUM / EVERGREEN HUCKLEBERRY
	WET RAIN GARDEN PLANTS BIOFILTRATION PLANTS FOR PARKING HOUSTONIA CORDATA / HEFSA HOUSTONIA MIMULUS GUTTATUS / SEED WORMFLOWER SCIRPUS MICROCARPUS / SMALL-FRUITED BULRUSH
	SHRUBS FOR BUFFER AREAS DECIDUOUS & EVERGREEN SHRUBS WITH GROUNDCOVER: 3 GAL. CONT. SHRUBS & 1 GAL. CONT. GROUNDCOVER ARCTOSTAPHYLOS UVA-URS / KINKINNICK BUXUS SEMPERVIRENS / AMERICAN BOXWOOD FOTHERGILLA GARDENII / DWARF FOTHERGILLA HYDRANGEA MACROPHYLLA / LARGELEAF HYDRANGEA HYDRANGEA GLABRIFOLIA / SINKLEAF HYDRANGEA POTENTILLA FRUTICOSA / BUSH CINQUEFOIL SYMPHORICARPOS ALBUS / COMMON WHITE SNOWBERRY

LEGEND

SYMBOL	NOTES	ACRES
	HARDSCAPE AREAS	18.51
	NATIVE VEGETATION AREAS MIXTURE OF NATIVE TREES, SHRUBS AND GROUNDCOVERS	4.57
	OPEN SPACE	3.38
	PEDESTRIAN SCALE LANDSCAPE	6.51
	TYPE III BUFFER - SEE THROUGH BUFFER DECIDUOUS & EVERGREEN TREES AT 30' O.C. WITH THE REMAINDER OF THE AREA PLANTED WITH SHRUBS AND GROUNDCOVERS.	

LANDSCAPE MASTER PLAN

HIGHLINE COLLEGE MASTER PLAN
JUNE 2016



McGRANAHAN architects

Highline College



BOWHALL MAPLE



COLUMNAR TULIP TREE



WESTERN HEMLOCK



WESTERN RED CEDAR



HINOKI FALSE CYPARIS



TRUE DWARF BOXWOOD



FOTHERGILLA



HYDRANGEA

PLANT LIST - DECIDUOUS & EVERGREEN TREES, SHRUBS



JEFFREY B. GLANDER & ASSOCIATES
AN SCJ ALLIANCE STUDIO

Highline College



MONKEY FLOWER



SMALL FRUITED BULRUSH



ASTILBE



HOULTUYNIA



KINNIKINNICK



KELSEY DOGWOOD



DOUGLAS SPIREA



DULL OREGON GRAPE



CEANOTHUS



WESTERN SWORD FERN



TUFTED HAIR GRASS



PACIFIC BLEEDING HEART



CINQUIFOIL

PLANT LIST - RAIN GARDEN, MED. SHRUBS



JEFFREY B. GLANDER & ASSOCIATES
AN SCJ ALLIANCE STUDIO



kpff Consulting Engineers
1000 1st Avenue, Suite 100
Des Moines, IA 50319
515.281.1100

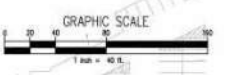
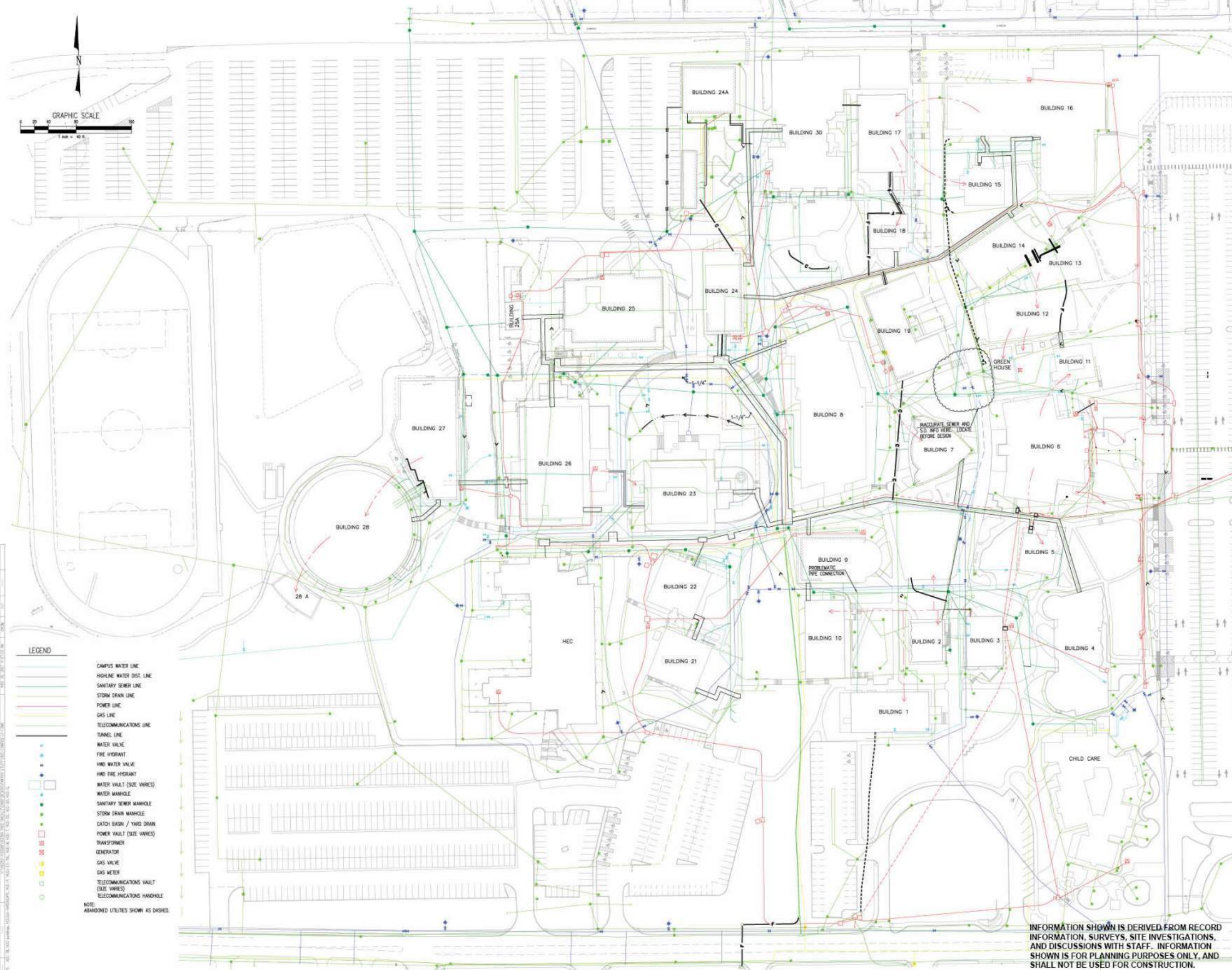

LEGEND

- CAMPUS WATER LINE
 - HIGHLINE WATER DIST. LINE
 - SANITARY SEWER LINE
 - STORM DRAIN LINE
 - POWER LINE
 - GAS LINE
 - TELECOMMUNICATIONS LINE
 - TUNNEL LINE
 - WATER VALVE
 - FIRE HYDRANT
 - HMD WATER VALVE
 - HMD FIRE HYDRANT
 - WATER VAULT (SIZE VARIES)
 - WATER MANHOLE
 - SANITARY SEWER MANHOLE
 - STORM DRAIN MANHOLE
 - CATCH BASIN / YARD DRAIN
 - POWER VAULT (SIZE VARIES)
 - TRANSFORMER
 - GENERATOR
 - GAS VALVE
 - GAS METER
 - TELECOMMUNICATIONS VAULT (SIZE VARIES)
 - TELECOMMUNICATIONS HANDHOLE
- NOTE: ABANDONED UTILITIES SHOWN AS DASHED.

HIGHLINE COMMUNITY COLLEGE
CAMPUS MAPPING
CITY OF DES MOINES, WASHINGTON

CAMPUS UTILITY PLAN

INFORMATION SHOWN IS DERIVED FROM RECORD INFORMATION, SURVEYS, SITE INVESTIGATIONS, AND DISCUSSIONS WITH STAFF. INFORMATION SHOWN IS FOR PLANNING PURPOSES ONLY, AND SHALL NOT BE USED FOR CONSTRUCTION.

U-1

06-06-2016



kpti Consulting Engineers
 501 15th Avenue, Suite 100
 Seattle, Washington 98101-3200
 (206) 467-8800 Fax (206) 467-8809



LEGEND

	CAMPUS WATER LINE
	HIGHLINE WATER DISTRICT LINE
	ABANDONED CAMPUS WATER LINE
	ABANDONED HMD WATER LINE
	WATER VALVE
	FIRE HYDRANT
	HMD WATER VALVE
	HMD FIRE HYDRANT
	Vault (SIZE VARES)
	WATER MANHOLE

NOTE:
 1. ALL HIGHLINE WATER DISTRICT LINES ARE 6" UNLESS OTHERWISE NOTED.

GRAPHIC SCALE
 0 20 40 60 80
 1" = 40'

**HIGHLINE COMMUNITY COLLEGE
 CAMPUS MAPPING**
 CITY OF DES MOINES, WASHINGTON

CAMPUS / HMD WATER PLAN

INFORMATION SHOWN IS DERIVED FROM RECORD INFORMATION, SURVEYS, SITE INVESTIGATIONS, AND DISCUSSIONS WITH STAFF. INFORMATION SHOWN IS FOR PLANNING PURPOSES ONLY, AND SHALL NOT BE USED FOR CONSTRUCTION.

U-2

06-06-2016



kpff Consulting Engineers
401 7th Avenue, Suite 1000
Des Moines, IA 50319
(515) 281-2200 Fax (515) 281-4200



LEGEND

- SANITARY SEWER LINE
- ABANDONED SANITARY SEWER LINE
- MANHOLE
- CAP

GRAPHIC SCALE
1 inch = 40 feet

**HIGHLINE COMMUNITY COLLEGE
CAMPUS MAPPING**
CITY OF DES MOINES, WASHINGTON

CAMPUS SANITARY SEWER PLAN

INFORMATION SHOWN IS DERIVED FROM RECORD INFORMATION, SURVEYS, SITE INVESTIGATIONS, AND DISCUSSIONS WITH STAFF. INFORMATION SHOWN IS FOR PLANNING PURPOSES ONLY, AND SHALL NOT BE USED FOR CONSTRUCTION.



kpff Consulting Engineers
 401 7th Avenue, Suite 100
 Seattle, WA 98101
 (206) 461-1100 Fax (206) 461-1101



LEGEND

- PROPOSED UPGRADES
- STORM DRAIN LINE
- MANHOLE
- CATCH BASIN / YARD DRAIN
- PIPE INLET/OUTLET
- ENGINEERED SMOKE

NOTE:
 1. ALL CFS, VDS AND RAIN LEADERS ARE 4"-8" UNLESS OTHERWISE NOTED.

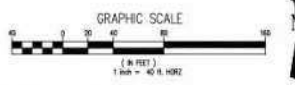

**HIGHLINE COMMUNITY COLLEGE
 CAMPUS MAPPING
 CITY OF DES MOINES, WASHINGTON**

CAMPUS STORM DRAIN PLAN

U-4
 06-06-2016

INFORMATION SHOWN IS DERIVED FROM RECORD INFORMATION, SURVEYS, SITE INVESTIGATIONS, AND DISCUSSIONS WITH STAFF. INFORMATION SHOWN IS FOR PLANNING PURPOSES ONLY, AND SHALL NOT BE USED FOR CONSTRUCTION.

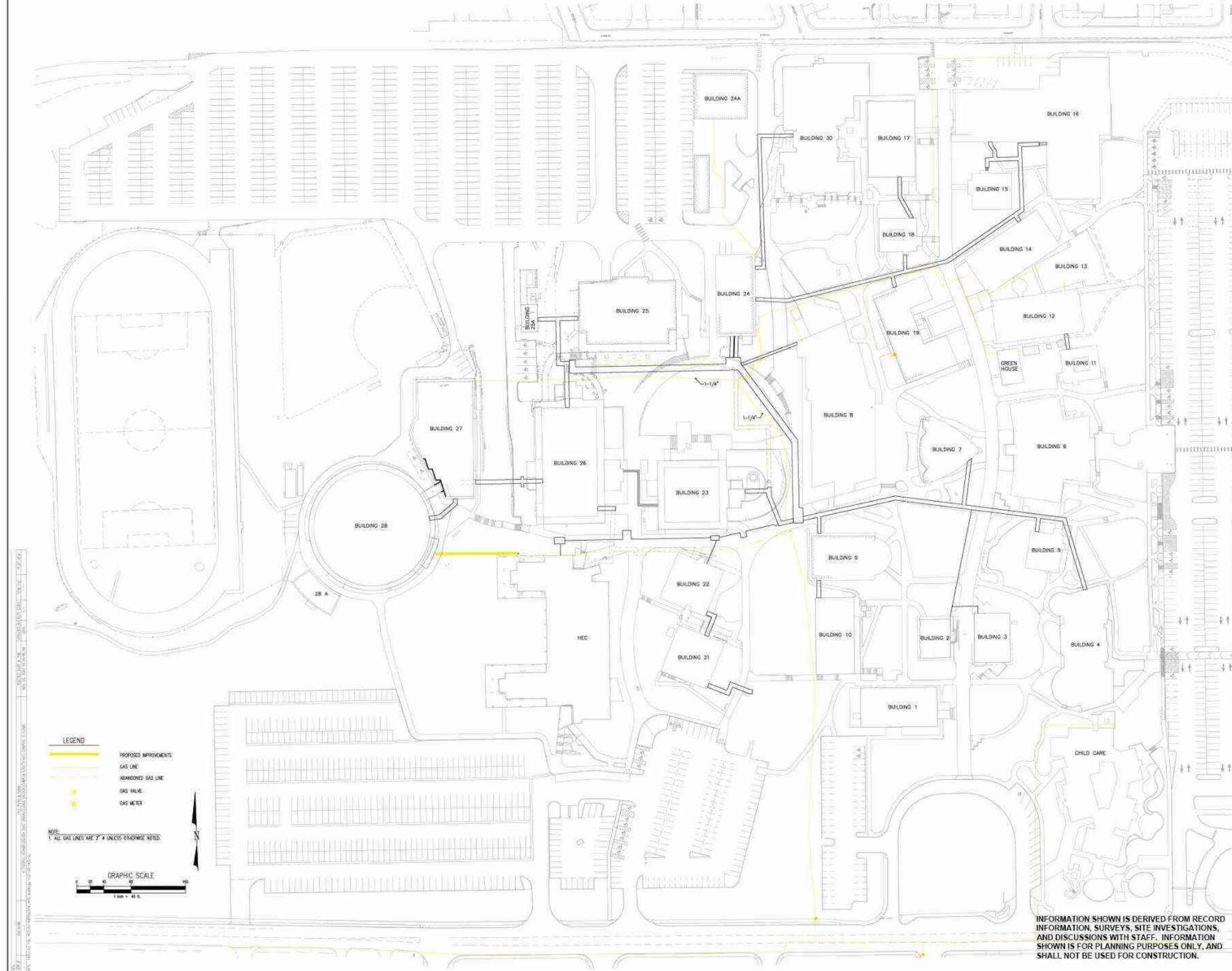

HIGHLINE COMMUNITY COLLEGE
 CAMPUS MAPPING
 CITY OF DES MOINES, WASHINGTON

CAMPUS GAS PLAN

U-5
 05-15-2016

INFORMATION SHOWN IS DERIVED FROM RECORD INFORMATION, SURVEYS, SITE INVESTIGATIONS, AND DISCUSSIONS WITH STAFF. INFORMATION SHOWN IS FOR PLANNING PURPOSES ONLY, AND SHALL NOT BE USED FOR CONSTRUCTION.

**HIGHLINE COMMUNITY COLLEGE
 CAMPUS MAPPING**
 CITY OF DES MOINES, WASHINGTON

CAMPUS POWER PLAN
 (PENDING FINAL REVIEW)



LEGEND

- PRIMARY POWER LINE
- - - ABANDONED PRIMARY POWER LINE
- - - BUILDING SERVICE LINE
- TRANSFORMER
- GENERATOR

GRAPHIC SCALE
 1 inch = 40 feet

INFORMATION SHOWN IS DERIVED FROM RECORD INFORMATION, SURVEYS, SITE INVESTIGATIONS, AND DISCUSSIONS WITH STAFF. INFORMATION SHOWN IS FOR PLANNING PURPOSES ONLY, AND SHALL NOT BE USED FOR CONSTRUCTION.



KPII Consulting Engineers
 3037 First Avenue, Suite 1000
 Seattle, Washington 98107-2000
 (206) 467-8888 Fax (206) 467-8128

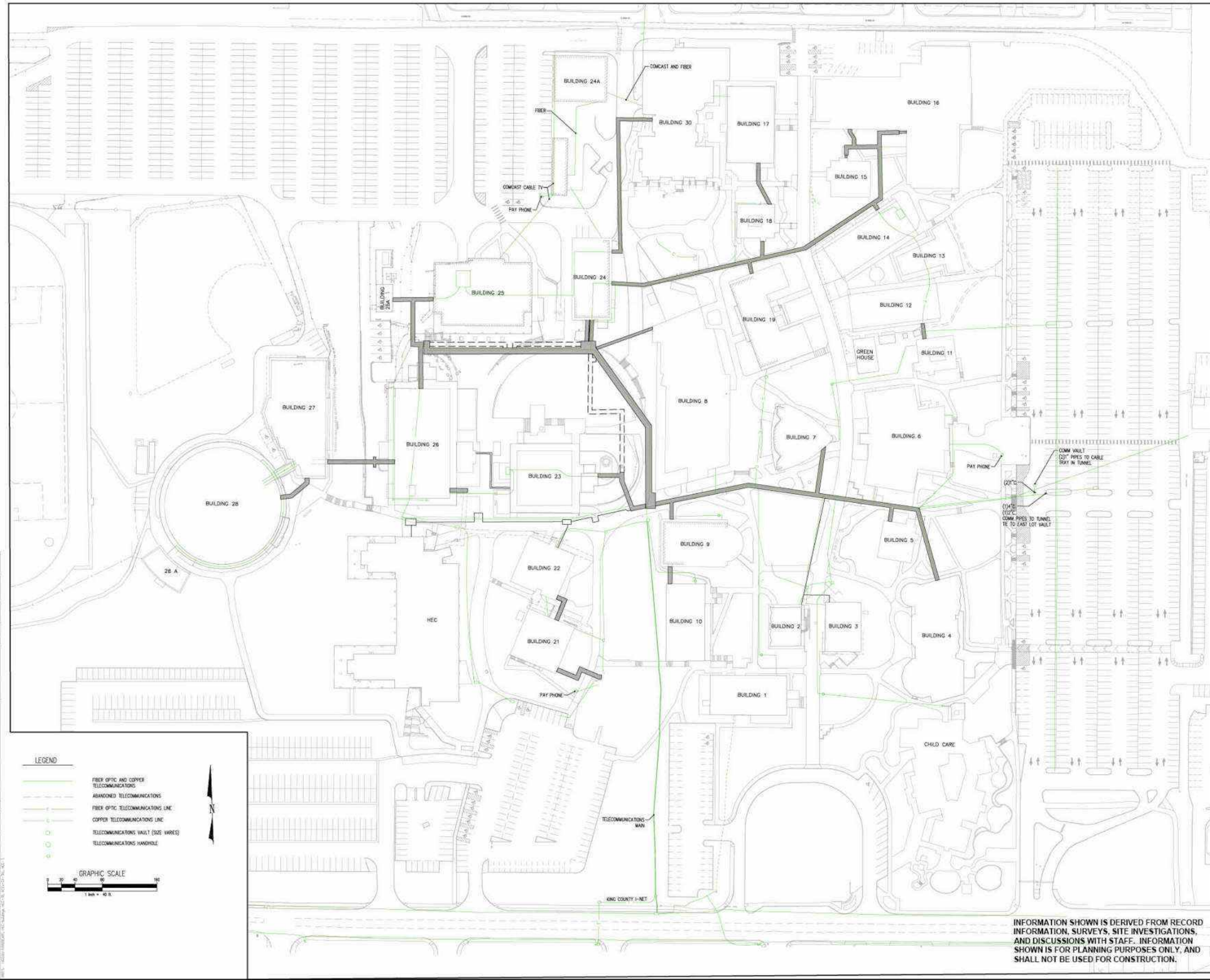

- LEGEND**
- FIBER OPTIC AND COPPER TELECOMMUNICATIONS
 - ABANDONED TELECOMMUNICATIONS
 - FIBER OPTIC TELECOMMUNICATIONS LINE
 - COPPER TELECOMMUNICATIONS LINE
 - TELECOMMUNICATIONS VAULT (SIZE VARIES)
 - TELECOMMUNICATIONS HANDHOLE

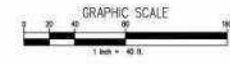

**HIGHLINE COMMUNITY COLLEGE
 CAMPUS MAPPING**
 CITY OF DES MOINES, WASHINGTON

CAMPUS TELECOMMUNICATIONS PLAN

INFORMATION SHOWN IS DERIVED FROM RECORD INFORMATION, SURVEYS, SITE INVESTIGATIONS, AND DISCUSSIONS WITH STAFF. INFORMATION SHOWN IS FOR PLANNING PURPOSES ONLY, AND SHALL NOT BE USED FOR CONSTRUCTION.

U-7
 06-06-2016



kpdl Consulting Engineers
and Architects Inc.
1000 1st Avenue, Suite 1000
Seattle, WA 98101
PH: 206.461.1000
FAX: 206.461.1001

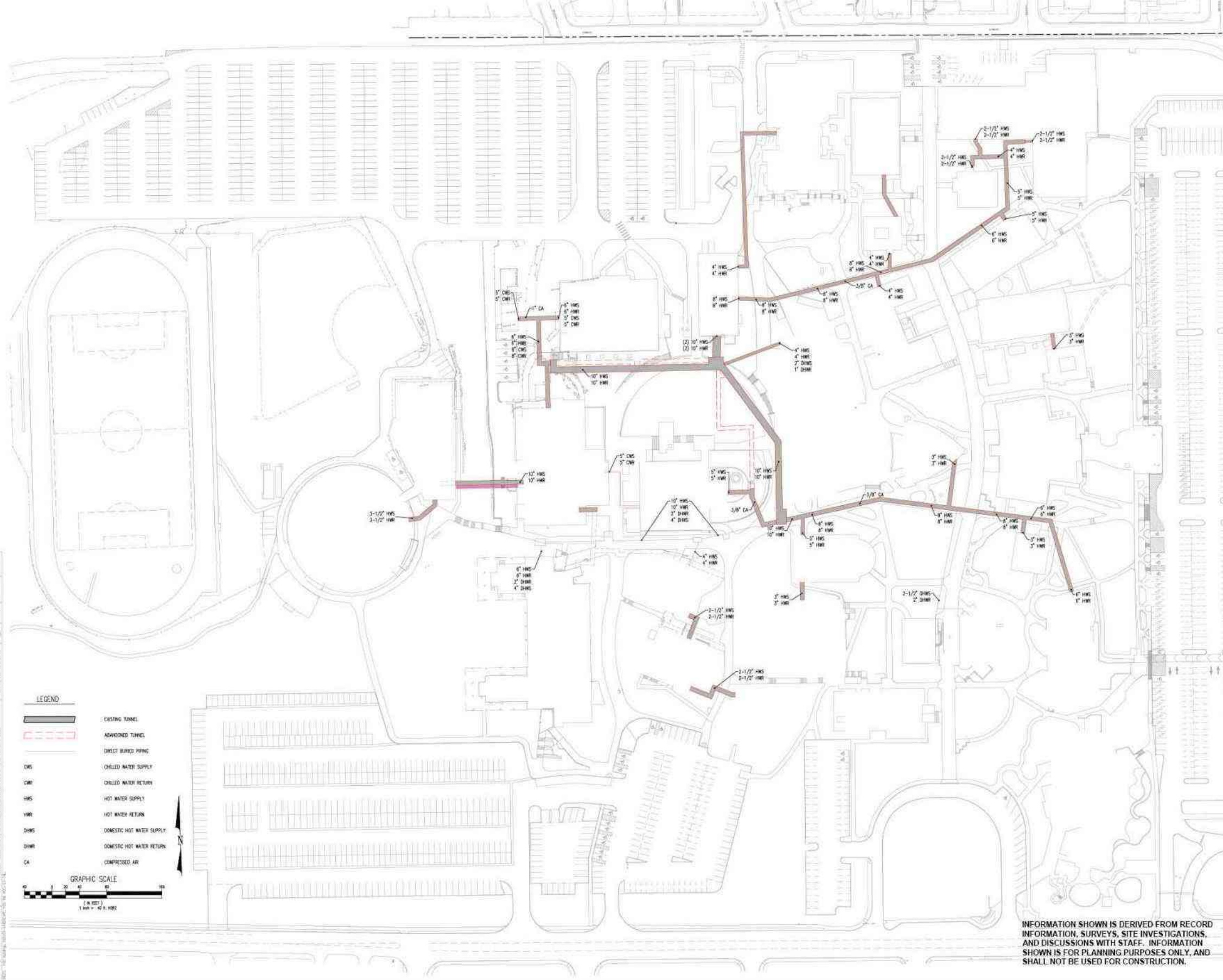

LEGEND

	EXISTING TUNNEL
	ABANDONED TUNNEL
	DIRECT BURIED PIPING
	CHILLED WATER SUPPLY
	CHILLED WATER RETURN
	HOT WATER SUPPLY
	HOT WATER RETURN
	DOMESTIC HOT WATER SUPPLY
	DOMESTIC HOT WATER RETURN
	COMPRESSED AIR

GRAPHIC SCALE
1" = 10' (AS SHOWN)
1" = 20' (AS SHOWN)

**HIGHLINE COMMUNITY COLLEGE
CAMPUS MAPPING**
CITY OF DES MOINES, WASHINGTON

CAMPUS MECHANICAL PLAN
U-8

INFORMATION SHOWN IS DERIVED FROM RECORD INFORMATION, SURVEYS, SITE INVESTIGATIONS, AND DISCUSSIONS WITH STAFF. INFORMATION SHOWN IS FOR PLANNING PURPOSES ONLY, AND SHALL NOT BE USED FOR CONSTRUCTION.

06-06-2016

